

2J410B-2J409

(DATASHEET)

Type	GPS passive body mount antenna
Frequencies	GALILEO E1 (1575.42 MHz) GPS (1575.42 MHz)
Mounting	Body Mount
Revision	00

Passive
High efficiency
Small design
Ideal for embedded applications



P. Tipul

1. SPECIFICATION

1.1. Electrical Specifications

Navigation (Cable 1)

Frequencies	GPS (1575.42 MHz) GALILEO E1 (1575.42 MHz)
Impedance	50 Ohms
Patch gain	3 dBiC
Patch size	25 x 25 x 4 mm
Polarization	RHCP
VSWR	<1.5:1

1.2. General Specifications

Operating temperature	-40°C to +85°C
Note	Passive antenna

1.3. Connection Specifications

Connector type: SMA male
 Cable: RG174U
 Cable length: 15 cm

For different cable length and connector type ask our sales team.

1.4. Mechanical Specifications and Dimensions

Material: ABS
 Max. dimensions: 40.99 mm x 42.75 mm x 17.6 mm
 Weight: 40 g 'weight counted with cable above'
 Colour: Black (for different colours please ask our sales team)

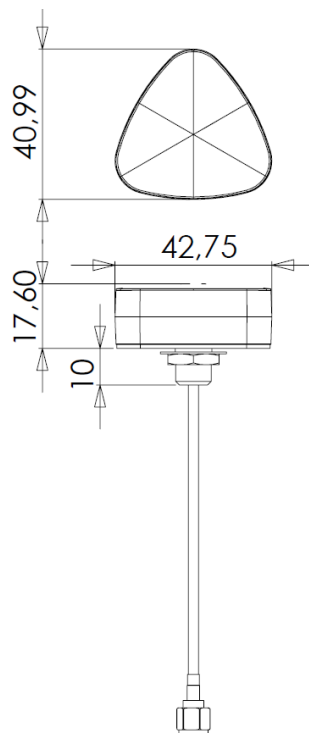

2. MEASUREMENT

- Measured with 30cm RG174 on 30x30cm metal ground plane.

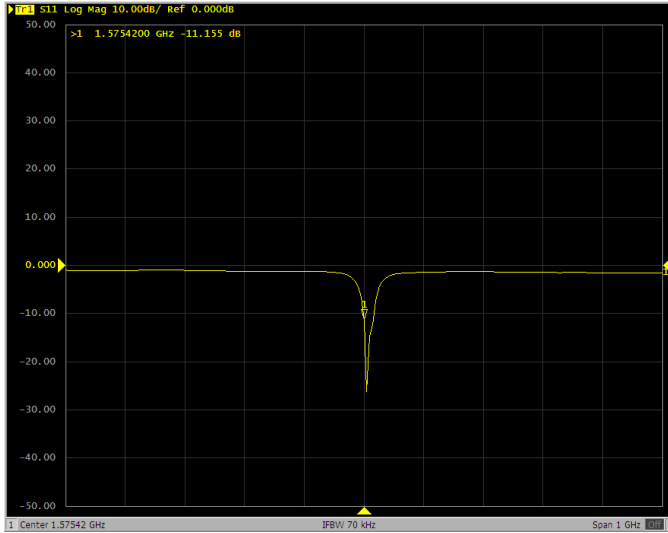

Figure 1 - S11 (Log Mag)

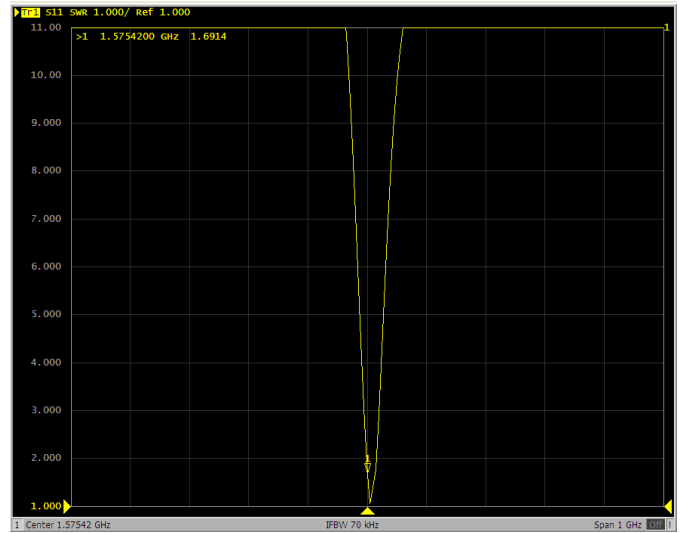

Figure 2 - S11 (VSWR)

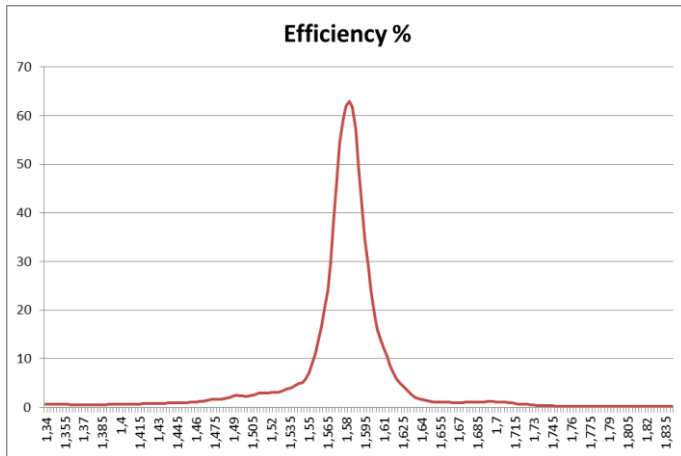

Figure 3 - Antenna efficiency (%)

Freq = 1.575GHz Az= 45 EL= 45

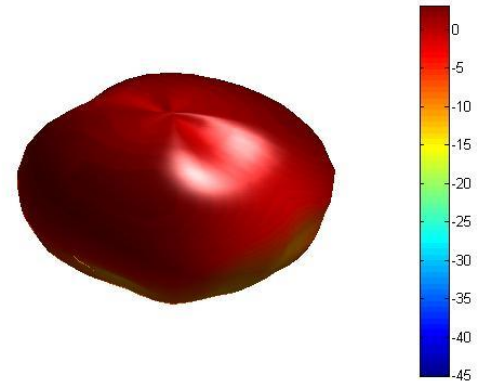

Figure 4 - 3D radiation pattern (dBi)

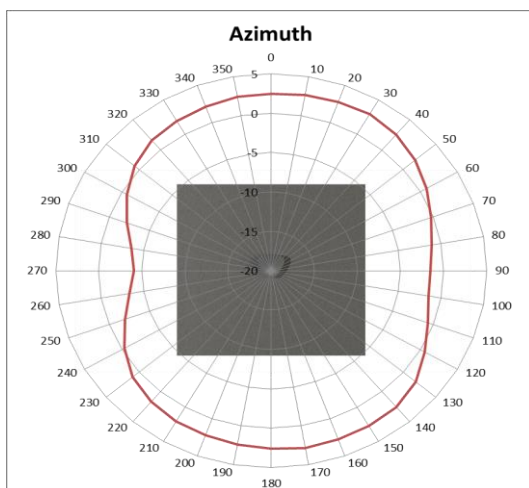

Figure 5 - Azimuth cut (dBiC)

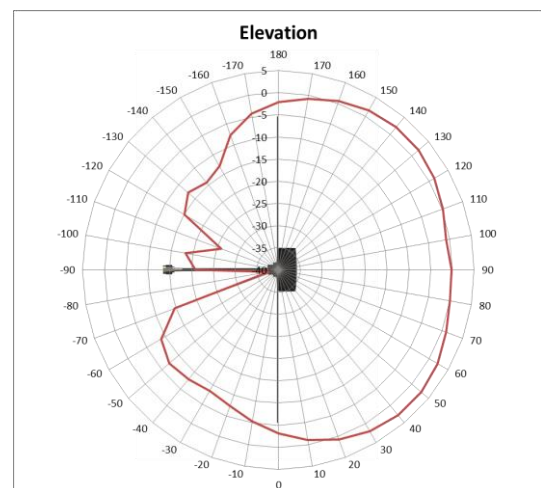

Figure 6 - Elevation cut (dBiC)

3. IMAGES

